



# BHAGWAN MAHAVIR HOSPITAL

Sponsored by: Mahasati Mohan Devi Jain Shikshan Samiti  
(CHARITABLE INSTITUTION)

SECTOR -14 EXTENSION, MADHUBAN CHOWK, ROHINI, DELHI - 110085

Phone : 011-27550440 / 41 / 42, M.: 9582585676

E-Mail : bhagwanmahavirhospital16@gmail.com

Website : www.bhagwanmahavirhospital.com



To

DT: 26.12.2022

Director  
Technia Institute of Advance Studies  
Sector-14 Rohini, Delhi-85

Dear Sir

As you are aware that our hospital viz Bhagwan Mahavir Hospital adjacent to your hospital is going to be constructed at the existing site for which we have to get permission to fell some trees of our hospital area for which we require a NOC from your Technia Institute of Advance Studies that we require for submission in tree felling application to be submitted in concerned department. The trees to be felled, transplanted compensatory plantation is 2/26/180 respectively, the sheet is hereby attached for your reference.

Thanking You



(Authorized Signatory)

Bhagwan Mahavir Hospital

Sponsored by Mahasati Mohan Devi Jain Shikshan Samiti

Project Name  
**Bhagwan Mahavir Super**  
**Speciality Hospital, Rohini, Delhi**

Client  
**Mahasati Mohan Devi Jain**  
**Shikshan Samiti**

Principal Consultants  
**INTEGRA VENTURES**  
 MULTIDISCIPLINARY CONSULTANCY  
 ARCHITECTURE | INTERIORS | MECHANICAL | ELECTRICAL | SANITARY

Consultant Architect  
**Creators Architects**

1109 HULI Tower, Noida, Sector 106, New Delhi 110034  
 Tel: +91 11 23091862  
 www.integraventures.com

BMSF DESIGN CONSULTANTS PVT LTD.  
 S13/25, GROUND FLOOR, DLF PHASE III -  
 GURGAON - 122002  
 PH: 0124-4113252  
 EMAIL: bmsf.sahni@gmail.com

Structure Consultant

Notes

- All drawings are to be read in conjunction with the specifications.
- Dimensions should be read and not assumed.
- The current version shall supersede previous drawings or revision of respective area.
- Drawing can not be used for construction or any other purpose unless stamped as Good for construction (GFC).
- Site engineer must complete architectural drawings and engineering drawings at site. Speed of information (emergency) to be provided. Previous drawings or revision of respective area. This drawing shall serve only for coordination for engineering services discipline. Details and technical specifications must be referred from engineering vendor drawings for electrical, mechanical, plumbing and other services. All relevant drawings shall be submitted to the consultant for approval. Intellectual copyright of the drawings shall remain with Creators Architects. No content shall be partially or fully used for any other purpose without written consent from the firm.

References  
 AR: Architecture  
 AV: Audio Video  
 ME: Mechanical  
 FR: Fire  
 HV: HVAC  
 MG: Mechanical  
 MS: Mechanical  
 PL: Plumbing  
 ST: Structure  
 Ven: Vendor

Environment plan

Scale: 1:125/250 A1/A3

Project Number: 2201

Sheet Size: A1/A3

Issue stamp

Geolocation: Delhi

Environment plan

Site plan  
 Showing Trees to be retain,  
 re-planted and removed.

Drawing Number: ES-001  
 Revision: R0  
 Date: 16.12.2022  
 © Creators Architects

Legend

Legend	Description	Numbers
	Total no. of existing trees	33
	Existing trees to be cut	02
	Existing trees to be transplanted out of the site	16
	Existing trees to be transplanted inside the site	10
	Existing trees to be retain	05
	Compensatory plantation (1:10) ie (2+16=18) =18x10	180

Tree No	Botanical Name	Common Name	Girm Dia. (mm)	Spread (mm)	Height (mm)	Comments
18.	Alstonia Scholaris	blackboard tree/Devil's Tree	350	3000	9000	Transplanted out side the site
19.	Mangifera indica	Mango	65	1500	4000	Transplanted out side the site
20.	Asadirachha indica	Item	447	10000	13000	Transplanted out side the site
21.	Prosopium Aemilium	Kanak Champia	447	8000	11000	To be retained
22.	Prosopium Aemilium	Kanak Champia	382	5000	12000	To be retained
23.	Siraca 2002	Ashoka	150	1000	2400	Transplanted inside the site
24.	Siraca 2002	Ashoka	150	1000	2400	Transplanted inside the site
25.	Siraca 2002	Ashoka	150	1000	2400	Transplanted inside the site
26.	Siraca 2002	Ashoka	150	1000	2400	Transplanted inside the site
27.	Siraca 2002	Ashoka	150	1000	2400	Transplanted inside the site
28.	Siraca 2002	Ashoka	150	1000	2400	Transplanted inside the site
29.	Siraca 2002	Ashoka	150	1000	2400	Transplanted inside the site
30.	Siraca 2002	Ashoka	150	1000	2400	Transplanted inside the site
31.	Siraca 2002	Ashoka	150	1000	2400	Transplanted inside the site
32.	Siraca 2002	Ashoka	150	1000	2400	Transplanted inside the site
33.	Bambusa Chaha	Common tree	477	7000	15000	To be retained

Tree No	Botanical Name	Common Name	Girm Dia. (mm)	Spread (mm)	Height (mm)	Comments
1.	Weigela floribunda	Focal Palm	350	4000	13000	Transplanted out side the site
2.	Ficus religiosa	Booth tree, peepul and sacred fig	177	14000	18000	To be cut
3.	Purranaya roborugii	Purranaya	382	4000	12000	To be cut
4.	Cassia Sanna	Kassod Tree	350	3000	12000	Transplanted out side the site
5.	Cassia Sanna	Kassod Tree	350	7000	13000	Transplanted out side the site
6.	Alstonia Scholaris	blackboard tree/Devil's Tree	318	2000	7000	Transplanted out side the site
7.	Morus alba	white mulberry	318	4000	8000	Transplanted out side the site
8.	Cassia Sanna	Kassod Tree	350	7000	13000	Transplanted out side the site
9.	Cassia Sanna	Kassod Tree	350	7000	7000	Transplanted out side the site
10.	Cassia Sanna	Kassod Tree	127	2000	4000	Transplanted out side the site
11.	Nycantia arbor-cristis	Hanging/Parrot Tree	48	2000	11000	Transplanted out side the site
12.	Jacaranda mimosifolia	Jacaranda	286	3000	15000	Transplanted out side the site
13.	Callistemon viminalis	Weeping Bottlebrush	350	4000	10000	Transplanted out side the site
14.	Alstonia Scholaris	blackboard tree/Devil's Tree	382	3000	11000	Transplanted out side the site
15.	Alstonia Scholaris	blackboard tree/Devil's Tree	414	4000	9000	Transplanted out side the site
16.	Alstonia Scholaris	blackboard tree/Devil's Tree	445	4000	11000	To be retained
17.	Alstonia Scholaris	blackboard tree/Devil's Tree	286	3000	10000	To be retained

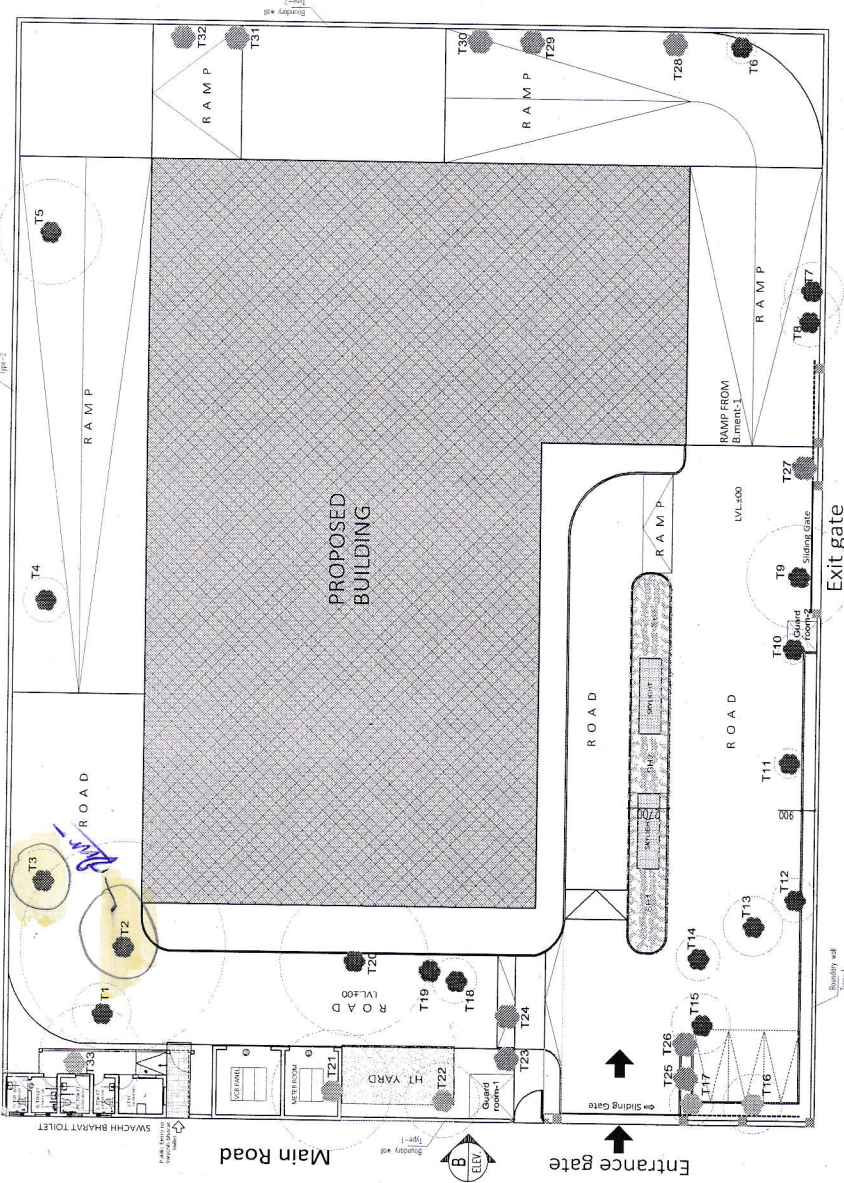



# TECNIA INSTITUTE OF ADVANCED STUDIES

GRADE "A" INSTITUTE

Approved by AICTE, Ministry of HRD, Govt. of India, Affiliated to GGSIP University  
Recognized Under Sec. 2(f) of UGC Act 1956

INSTITUTIONAL AREA MADHUBAN CHOWK, ROHINI, DELHI 110085

Tel: 91-11-27555121-24, E-Mail: directortias@tecnia.in, Website: www.tiaspg.tecniain



Ref. No. TIAS/Dir.Off./2022-23/26

Dated: 27.12.2022

The President,  
Bhagwan Mahavir Hospital  
Sponsored by Mahasati Mohan Devi Jain Shikshan Smiti,  
Sector-14, Rohini, Delhi

**Subject: NOC for tree to be felled by Bhagwan Mahavir Hospital, Sector-14, Rohini, Delhi.  
(in adjacent premises of Tecnia Institute of Advanced Studies)**

Dear Madam/ Sir,

This is in reference to the letter No. Nil Dated: 26.12.2022 issued by Authorized Signatory, Bhagwan Mahavir Hospital, Sponsored by Mahasati Mohan Devi Jain Shikshan Smiti with a request of issuance of NOC for felling some trees in their hospital area premises (under construction) with a sheet providing details of plan of transplanting compensatory plantation in a ratio of 2 (removal)/26 (transplantation)/180 (new plantation) by in the Bhagwan Mahavir Hospital in some other alternative site and assured us to follow the rules and regulations of the Department of Environment, Forest & Wildlife, Government of NCT of Delhi in its letter and spirit.

Tecnia Institute of Advanced Studies, being an accredited Higher Education Institute affiliated with GGSIP University with an active Exceptionally Performing ECO Club; Awarded with Certificate of Excellence for contribution to safe guarding Environment of Delhi on Eve of World Environment Day, 2022 by Department of Environment, Forest & Wildlife, Government of NCT of Delhi (copy attached). Our ECO Club will undergo MoU to cooperate with your organization and adopt the remaining trees in your premises for monitoring the wellbeing of trees and protect the environment.

Institute has '**No Objection**' for felling/ transplantation of trees in the adjacent premises of Bhagwan Mahavir Hospital, Sponsored by Mahasati Mohan Devi Jain Shikshan Smiti, Sector-14, Rohini, Delhi (in adjacent premises of Tecnia Institute of Advanced Studies)

  
**DIRECTOR**  
Tecnia Institute of Advanced Studies  
(Affiliated to GGSIP University Delhi)  
Madhuban Chowk, Rohini, Delhi-85



Department of Environment,  
Forest & Wildlife  
Government of NCT of Delhi

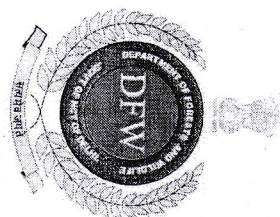

# CERTIFICATE OF EXCELLENCE

Awarded to

*Tejvia Institute of Advanced Studies*

For contribution to safe guarding Environment of Delhi

On Eve of World Environment Day, 2022 for being an exceptionally performing Eco Club.

Hon'ble Minister  
(Environment & Forest)